

Seaford Road, W13

LONG LET. This beautiful two bedroom garden flat enjoys the benefits of both Northfield Avenue and West Ealing Broadway.

- GARDEN FLAT
- BORDERS OF NORTHFIELDS & WEST EALING
- PRIVATE BALCONY
- LARGE RECEPTION ROOM
- CLOSE TO THE ELIZABETH LINE

£2,100 PCM

Seaford Road

Approximate Gross Internal Area
732 sq ft - 68 sq m

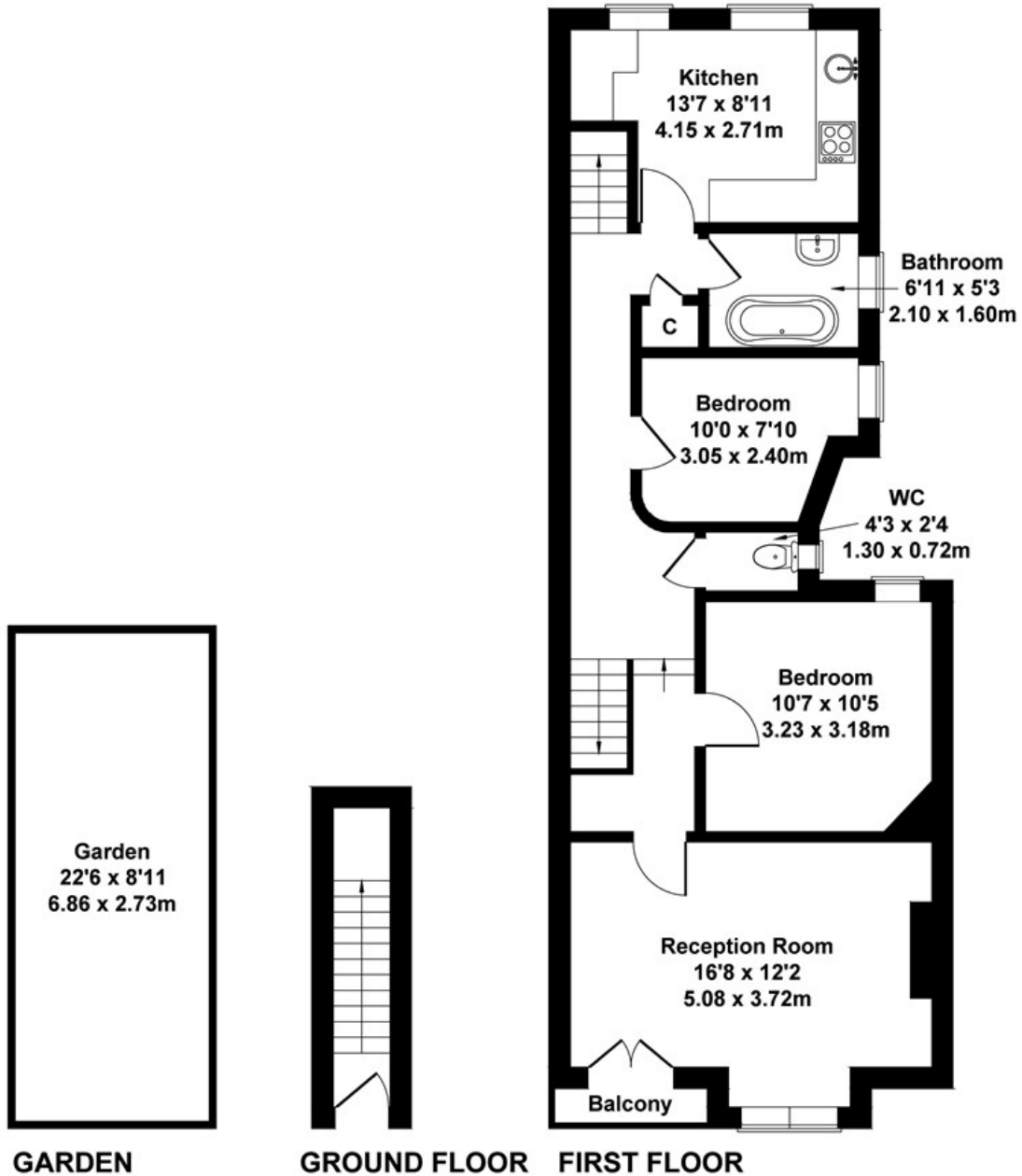
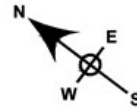

Not to Scale. Produced by The Plan Portal 2021
For Illustrative Purposes Only.

Energy Efficiency Rating		
	Current	Potential
<i>Very energy efficient - lower running costs</i>		
(92 plus) A		
(81-91) B		
(69-80) C		
(55-68) D		
(39-54) E		
(21-38) F		
(1-20) G		
<i>Not energy efficient - higher running costs</i>		
England & Wales	EU Directive 2002/91/EC	